

FALCON SERIES LED STREET LIGHT

20W-150W

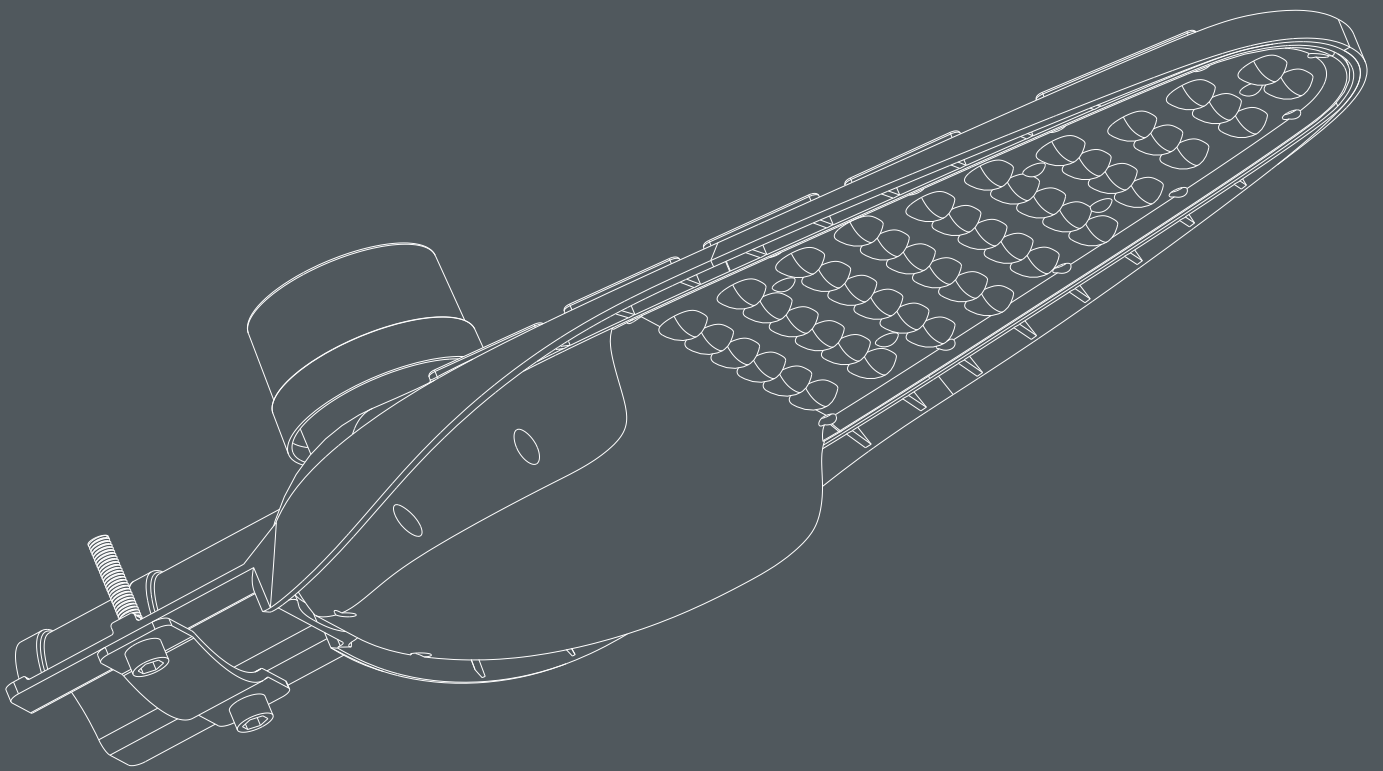

20W-100W



110W-150W



1. Features

1. MasonLED patent design with unique appearance.
2. High ingress protection IP66 ensures long service life.
3. High impact protection IK10 with die-casting aluminium construction.
4. The smooth housing back ensures excellent heat dissipation free of dust accumulation.
5. Falcon serves excellent lumen efficiency can up to 150 lm/w.
6. Leading quality brands for LEDs and drivers. Lumileds LED and Sosen/Inventronics drivers.
7. NEMA receptacle, photo sensor available.
8. 10KV surge protection device optional.
9. Perfectly match the street light pole arm diameter from 40mm to 60mm.
10. Easy going assembly solution for SKD buyers.

2. Application



Urban Secondary Road, Branch Road, Rural Road, Park Landscape Road, Commercial Residential Road.

3. Overall dimensions



Falcon Series LED Street Light
20W-150W

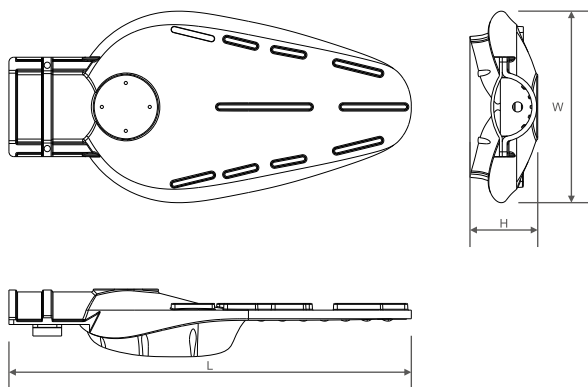

Model No.	Product Size(L*W*H)mm
MS-ST881020	350*165*64
MS-ST882030	350*165*64
MS-ST883040	420*200*71
MS-ST884050	420*200*71
MS-ST885060	546*260*80
MS-ST886070	546*260*80
MS-ST887080	546*260*80

Model No.	Product Size(L*W*H)mm
MS-ST888090	546*260*80
MS-ST889100	546*260*80
MS-ST1042110	655*312*91
MS-ST1043120	655*312*91
MS-ST1044130	655*312*91
MS-ST1045140	655*312*91
MS-ST1046150	655*312*91

4. Light distribution curve

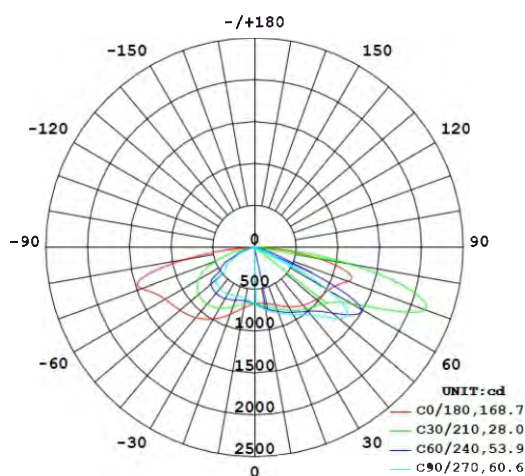
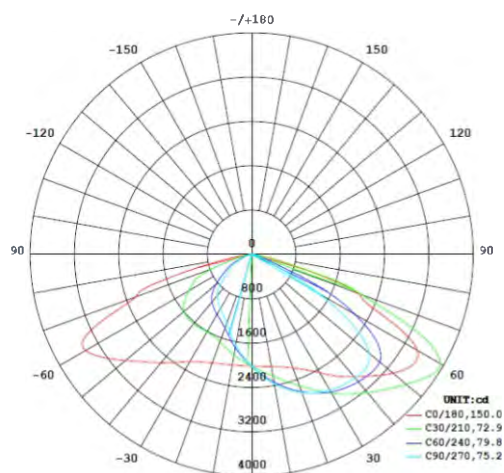

Type II-S (20-100W) ,Type III-S (20-150W)
More optical options/requirements please contact our sales.

5. Technical parameters

Model No.	MS-ST881 020	MS-ST882 030	MS-ST883 040	MS-ST884 050	MS-ST885 060	MS-ST886 070	MS-ST887 080	MS-ST888 090	MS-ST889 100
Input voltage	120-277V								
Power factor	>0.95								
System power	20W	30W	40W	50W	60W	70W	80W	90W	100W
LED type	3030								
Luminous efficiency	130-150lm/W				140-170lm/W				
CCT	3000K/4000K/5700K/6500K								
CRI	>70								
IP	IP66								
IK	IK10								
Lifespan	50000H								
Net weight (kg)	1.8		2.2			3.1			
Package size (mm)	350*165*64		420*200*71			546*260*80			
Coating color	Dark grey(other painting is also available for MOQ500pcs per model)								

5. Technical parameters

Model No.	MS-ST1042 110	MS-ST1043 120	MS-ST1044 130	MS-ST1045 140	MS-ST1046 150
Input voltage	120-277V				
Power factor	>0.95				
System power	110W	120W	130W	140W	150W
LED type	3030				
Luminous efficiency	140-180lm/W			140-170lm/W	
CCT	3000K/4000K/5700K/6500K				
CRI	>70				
IP	IP66				
IK	IK10				
Lifespan	50000H				
Net weight (kg)	4.5				
Package size (mm)	655*312*91				
Coating color	Dark grey(other painting is also available for MOQ500pcs per model)				

Packaging

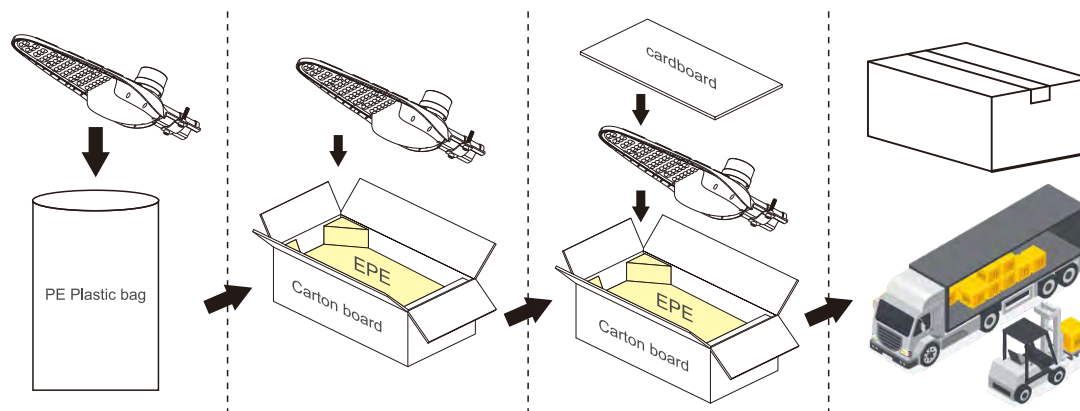

Luminaire power	Carton size (outer box)(mm)	Qty per carton	Packing volume (outer box)
20W-30W	405*220*125	1	0.011
40W-50W	510*248*195	1	0.024
60W-100W	690*315*350	2	0.076
110W-150W	710*365*145	1	0.038

6. Installation

LED Streetlight

Mounting instruction



Ta
50°



Model Number	Product Size	Power	Rated Voltage	Frequency
MS-ST881020-PW	350*165*64MM	20W	120-277V 50/60Hz	
MS-ST882030-PW		30W		
MS-ST883040-PW		40W		
MS-ST884050-PW	420*200*71MM	50W		
MS-ST885060-PW		60W		
MS-ST886070-PW		70W		
MS-ST887080-PW	546*260*80MM	80W		
MS-ST888090-PW		90W		
MS-ST889100-PW		100W		
MS-ST1042110-PW	655*312*91MM	110W		
MS-ST1043120-PW		120W		
MS-ST1044130-PW		130W		
MS-ST1045140-PW		140W		
MS-ST1046150-PW		150W		

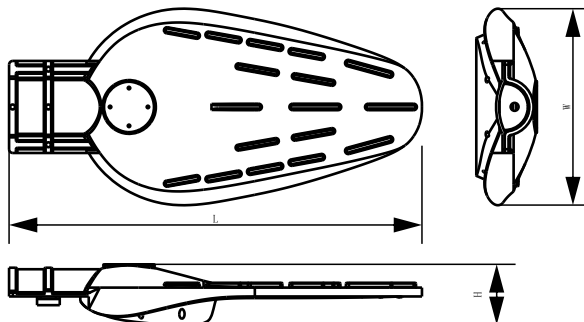

Installation Instruction:

1. Open the packing to check if the product is consistent with the demand, whether product surface is intact and the function meets with the requirement.

2. Fixture installation

2.1) Open the packing of the photocell, plug it in the socket, screw it in clockwise(picture 1)(With photocell option)

2.2) Plug Allen Key in the specified position, screw in the direction of arrow(picture 2)

2.3) Connect the wire of the fixture with cable of the pole correctly (picture3)

2.4) Put the streetlight arm into the specified position of streetlight, lock the screw

Mark: The cable outside must meet with 60245 IEC57 standard, and cross-sectional area is not less than $3 \times 1.0\text{mm}^2$

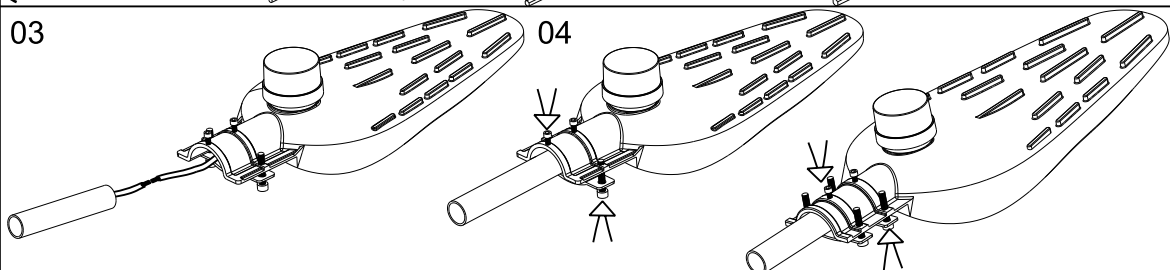
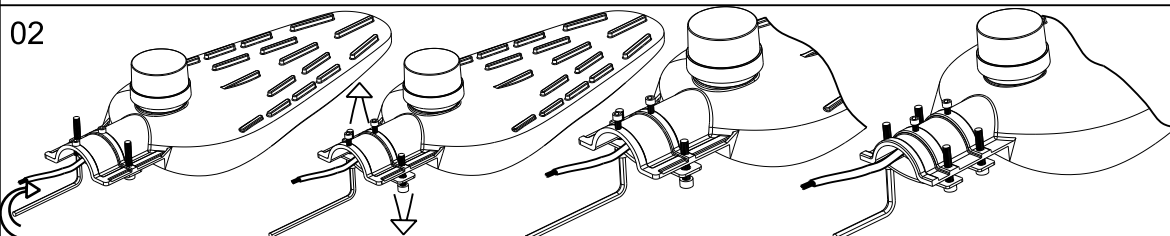
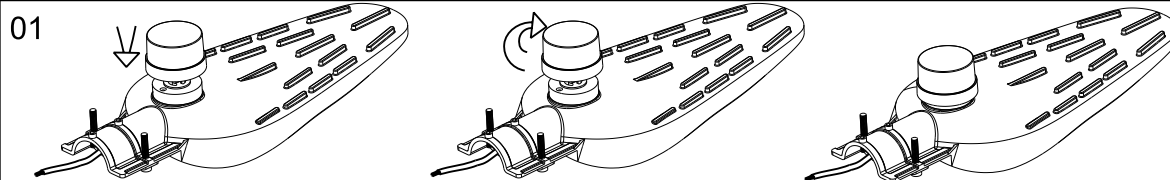

Streetlight arm requirement and installation

1. 20-30W suit light arm outer diameter range $\Phi 42$;

2. 40-150W suit light arm outer diameter range $\Phi 42$ - $\Phi 60$;

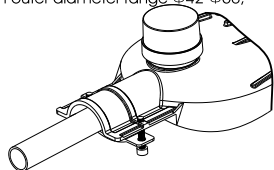

Attention:

1. Check luminaire cable before wiring.
2. Ensure the power has been switched off.
3. Wire according to the cable color.
4. It's normal the temperature on luminaire surface rise a little when working.
5. The light source of this luminaire is not replaceable, when the light source reaches its end of life the whole luminaire shall be replaced.
6. If the cord of this luminaire is damaged, it shall be exclusively replaced by the manufacturer or his service agent or a similar qualified person in order to avoid a hazard.

7. Street light brackets and adaptor

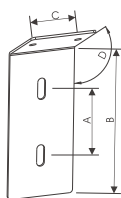

Serial number	Product Size			
	A(MM)	B(MM)	C(MM)	D(°)
A1	95	210	72	15
A2	95	210	87	15
A3	95	210	100	15

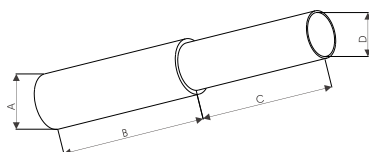

Serial number	Product Size			
	A(MM)	B(MM)	C(MM)	D(MM)
B1	∅60	100	100	∅40
B2	∅60	100	100	∅50
B3	∅60	100	100	∅60

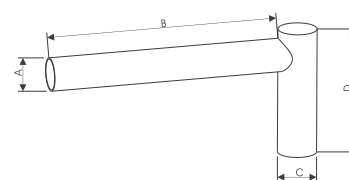

Serial number	Product Size			
	A(MM)	B(MM)	C(MM)	D(MM)
C1	∅40	300	∅60	240
C2	∅50	300	∅60	240
C3	∅60	300	∅60	240

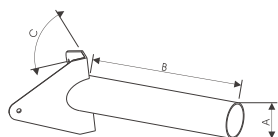

Serial number	Product Size		
	A(MM)	B(MM)	C(°)
D1	40	300	90
D2	50	300	90
D3	60	300	90

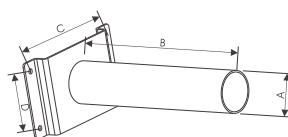

Serial number	Product Size			
	A(MM)	B(MM)	C(MM)	D(MM)
E1	∅40	300	120	100
E2	∅50	300	120	100
E3	∅60	300	120	100

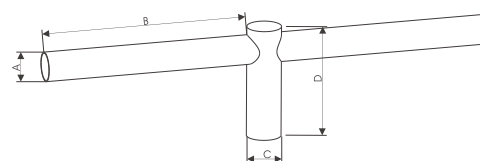

Serial number	Product Size			
	A(MM)	B(MM)	C(MM)	D(MM)
F1	∅40	300	∅60	240
F2	∅50	300	∅60	240
F3	∅60	300	∅60	240

8. Transportation and storage requirements

Street lamps are packed in cartons, which are not allowed to be subjected to severe mechanical impact and exposure to the sun and rain during transportation. Street light should be stored in a cool, dry, clean environment, storage temperature is -20°C to 50°C .

9. Precautions

Read the instruction manual carefully before use to avoid accidents and damage. This product is maintenance-free and generally does not require maintenance. Please contact us if you need repair. Street lamps should be carefully checked before use. If abnormal phenomena are found during use, please contact us. When used, the surface of the luminaire has a certain temperature rise, which is normal.

10. Safety alert

Before installation, the street lights must be in good condition for installation. Do not apply external force or throw to the street light. Street lamps should be stored in a cool, dry, clean environment before installation. Do not put them in water or fire. Scrapped street lights should not be discarded at random and should be placed at the designated location for uniform processing.